

Recommended PCB Layout

Solder Area

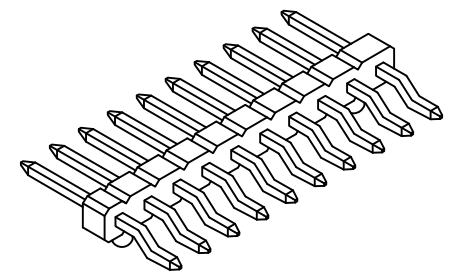
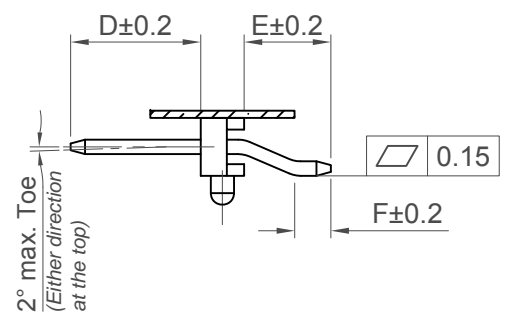

Specifications

Material
 Insulator: LCP, UL94V-0, Black
 Standard: Polyamide, Nylon 6T, UL 94V-0
 Options: Polymer, LCP, UL 94V-0
 Contact Terminal: Copper Alloy

Plating
 Underplating: Nickel all over
 Contact Area: Gold Flash or 15µ" Gold

Electrical
 Current Rating: 2A per pin
 Contact Resistance: 20 mΩ max.
 Insulating Resistance: 1000 MΩ min.
 Dielectric Withstand Voltage: 500V AC

Mechanical & Environmental
Soldering Process:
 Nylon 6T (Standard) -
 IR Reflow: 260°C for 10 sec.
 Manual Solder: 350°C for 3-5 sec
 LCP (Option) -
 IR Reflow: 260°C for 10 sec.
 Manual Solder: 350°C for 3-5 sec
Operating Temperature:
 Gold Plating: -40°C to +125°C
 Tin Plating: -40°C to +105°C

Mates with (Subject to pin length)
 BF070 BF085 BF086 BF090
Perfect Planar Mating with (Subject to pin length)
 BF087 BF088

Number of Contacts	Dimensions		
	A	B	C
3	4.0	6.0	2.0
4	6.0	8.0	4.0
5	8.0	10.0	6.0
6	10.0	12.0	8.0
7	12.0	14.0	10.0
8	14.0	16.0	12.0
9	16.0	18.0	14.0
10	18.0	20.0	16.0
11	20.0	22.0	18.0
12	22.0	24.0	20.0
13	24.0	26.0	22.0
14	26.0	28.0	24.0
15	28.0	30.0	26.0
16	30.0	32.0	28.0
17	32.0	34.0	30.0
18	34.0	36.0	32.0
19	36.0	38.0	34.0
20	38.0	40.0	36.0
21	40.0	42.0	38.0
22	42.0	44.0	40.0
23	44.0	46.0	42.0
24	46.0	48.0	44.0
25	48.0	50.0	46.0
26	50.0	52.0	48.0
27	52.0	54.0	50.0
28	54.0	56.0	52.0
29	56.0	58.0	54.0
30	58.0	60.0	56.0
31	60.0	62.0	58.0
32	62.0	64.0	60.0
33	64.0	66.0	62.0
34	66.0	68.0	64.0
35	68.0	70.0	66.0
36	70.0	72.0	68.0
37	72.0	74.0	70.0
38	74.0	76.0	72.0
39	76.0	78.0	74.0
40	78.0	80.0	76.0

Ordering Grid

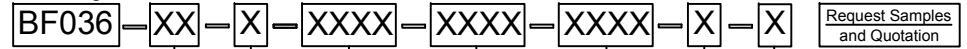

No. of Contacts
03 to 40

Contact Plating

A = Gold Flash All Over (Standard)
 B = Selective Gold Flash Contact Area/
 Tin On Tail
 C = Tin All Over
 G = 10µ" Gold Contact Area/Tin On Tail
 I = 30µ" Gold Contact Area/Tin On Tail

Dimension D (1/100mm) (Post Length)
0400 = 4.00mm (Standard)
 Or specify custom Post Length
 eg 0250 = 2.50mm
 (Maximum 1000 = 10.00mm)
 (Minimum 0100 = 1.00mm)

Packing Options
C = Tape and Reel with Film (Standard)
 D = Tube
Insulator Material
N = Nylon 6T (Standard)
 L = LCP

Dimension F (1/100mm) (Pin Curve to End of Pin)
0127 = 1.27mm (Standard-Minimum)
 Or specify custom 'Pin Curve to End of Pin' length
 eg 0170 = 1.70mm (Maximum length)

Dimension E (1/100mm) (Insulator to End of Pin)
0300 = 3.00mm (Standard)
 Or specify custom 'Insulator to End of Pin' length
 eg 0250 = 2.50mm (Minimum)
 (Maximum 0500 = 5.00mm)

Part Number		Product Description	
BF036		2.00mm Pitch Pin Header	
Drawing Date		Single Row, SMT, Horizontal with Locating Peg	
19th May 2010			
By	CC	Tolerances (Except as Noted)	Units:
Detail	BF036 C PCN	Length X. ± 0.30 X.X ± 0.25 X.XX ± 0.15 X.XXX ± 0.10	Metric (mm)
Revision	C5	Angle X.X° ± 5° X.XX° ± 3° X.XXX° ± 2° X.XXX° ± 1°	
Date	28/09/17		



This drawing is confidential and copyright of Global Connector Technology, Ltd (GCT). This drawing must not be copied or disclosed without written consent. E & OE



Not to Scale	Drawn By SA	Sheet No. 1/1
--------------	-------------	---------------