

Recommended PCB Layout

Solder Area

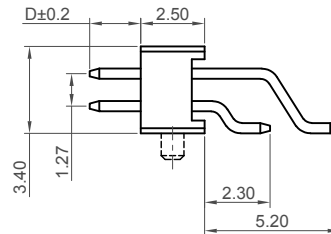

Ordering Grid

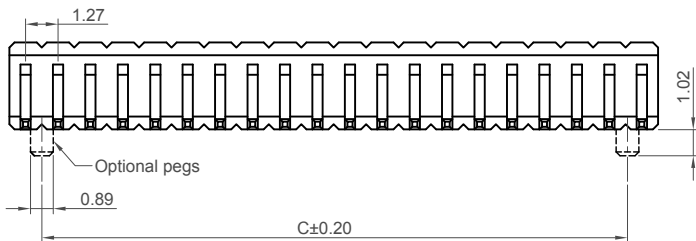
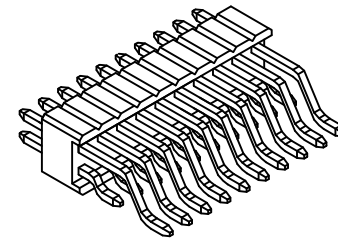

No. of Contacts
06 to 66

Contact Plating

- A = Gold Flash All Over (Standard)**
- B = Selective Gold Flash Contact Area/
Tin On Tail
- C = Tin All Over
- D = 10µ" Gold All Over
- G = 10µ" Gold Contact Area/Tin On Tail
- I = 30µ" Gold Contact Area/Tin On Tail

Locating Peg

- 0 = Without Peg
- 1 = With Peg

Packing Options

- B = Tape & Reel with Cap (Standard)**
- D = Tube
- E = Tube with Cap

Insulator Material

- L = LCP (Standard)**
- N = Nylon 6T

Dimension D (1/100mm) (Post Length)

0190 = 1.90mm (Standard)
or specify Dimension D
eg 0250 = 2.50mm
Tol +/- 0.2mm
(Maximum 0800=8.00mm)
(Minimum 0100=1.00mm)

Specifications

Material

- Insulator Material:
- Standard: Polymer, LCP, UL 94-V0
- Option: Polyamide, Nylon 6T, UL 94-V0
- Contact Terminal: Copper Alloy

Plating

See Ordering Grid

Electrical

- Current Rating: 1 Amp per pin
- Contact Resistance: 20 mΩ max.
- Insulation Resistance: 1000 MΩ min.
- Dielectric Withstand Voltage: 300 V AC

Mechanical & Environmental

- Operating Temperature: -40°C to +105°C
- Soldering Process:
- LCP (Standard) -
- IR Reflow: 260°C for 10 sec.
- Manual Solder: 350°C for 3-5 sec
- Nylon 6T (Option) -
- IR Reflow: 260°C for 10 sec.
- Manual Solder: 350°C for 3-5 sec

Mates with (Subject to pin length):

- BD050 BD055 BD060 BD064
- BD065 BD091 BD092 BD093

Contacts	Dimensions		
	A	B	C
6	2.54	3.81	1.27
8	3.81	5.08	2.54
10	5.08	6.35	3.81
12	6.35	7.62	5.08
14	7.62	8.89	6.35
16	8.89	10.16	7.62
18	10.16	11.43	8.89
20	11.43	12.70	10.16
22	12.70	13.97	11.43
24	13.97	15.24	12.70
26	15.24	16.51	13.97
28	16.51	17.78	15.24
30	17.78	19.05	16.51
32	19.05	20.32	17.78
34	20.32	21.59	19.05
36	21.59	22.86	20.32
38	22.86	24.13	21.59
40	24.13	25.40	22.86
42	25.40	26.67	24.13
44	26.67	27.94	25.40
46	27.94	29.21	26.67
48	29.21	30.48	27.94
50	30.48	31.75	29.21
52	31.75	33.02	30.48
54	33.02	34.29	31.75
56	34.29	35.56	33.02
58	35.56	36.83	34.29
60	36.83	38.10	35.56
62	38.10	39.37	36.83
64	39.37	40.64	38.10
66	40.64	41.91	39.37

Part Number		Product Description	
BD038		1.27mm Pitch Socket, Dual Row, Surface Mount, Horizontal	
Drawing Date		3rd April 2008	
By	CC	Tolerances (Except as Noted)	Units:
Detail	BD038 D PCN	Length X. ± 0.30 XX ± 0.20 XXX ± 0.15 X.XXX ± 0.10	Angle X° ± 5° X.X° ± 2° X.XX° ± 1° X.XXX° ± 0.5°
Revision	D3	Metric (mm)	
Date	06/08/20		



This drawing is confidential and copyright of Global Connector Technology, Ltd (GCT). This drawing must not be copied or disclosed without written consent. E & OE



www.gct.co

Not to Scale	Drawn By AE	Sheet No. 1/1
--------------	-------------	---------------